

Farécla has been meeting the needs of the automotive refinish industry for over 50 years. The products are now available on all five continents in 85 countries worldwide.

For details of your nearest Farécla distributor, please call +44 (0)1920 465 041 or e-mail us at [enquiries@farecla.com](mailto:enquiries@farecla.com)

**Farécla**<sup>™</sup>  
world-class surface finishing

At Farécla we believe in providing quality products that give the best results for the task in hand.

We specialise in developing integrated systems for preparation, rectification and finishing – making the process as simple as possible whilst saving bodyshops time and money.

Our on-going commitment to investment in research and development enables us to provide products of excellence that are recognised in the automotive trade throughout the world and by many, they are considered to be the finest.



When carrying out local repairs or blending in new paintwork, the use of a flattening liquid ensures a more even key over the panel. It also helps to prevent deep scratches or tramlines which can sometimes show through the clearcoat.

The Advanced G Matt range offers the user an innovative solution to common preparation problems. The combined action of the flattening block, pad and liquid produces a consistent key, resulting in paint adhesion you can rely on.



### For preparing the perfect surface

- ◆ FARECLA ADVANCED G MATT LIQUID
- ◆ ADVANCED G MATT FLATTING BLOCK & PAD
- Creates an even matt finish
- Does not stain mouldings or trim
- Contains detergent to remove wax and traffic film
- Reduces the amount of effort required
- Makes awkward areas easy to prepare



PRODUCT	CODE	PACK SIZE	CTN QTY	VOC
Advanced G Matt Liquid	AGMATT-500	500 ml	12	Nil
Advanced G Matt Flattening Block	AGMATT-BLOC	1 x block	6	Nil
Advanced G Matt Flattening Pads	AGMATT-PAD	10 x pads	6	Nil
Advanced G Matt System	AGMATT-SYS	Kit	6	Nil

Full material safety data sheet is available on request



Farécla offer a range of integrated surface finishing systems that cater for the needs of today's busy bodyshop, each of which comprises of a specially developed compound and applicator.

The versatile "Essential System" is based on the renowned G3, while the other systems have been developed to achieve optimum results for specific tasks.



PRODUCT INFORMATION **A B**

### The essential system



- ◆ FARECLA ADVANCED G3 LIQUID/FARECLA G3 REGULAR GRADE PASTE
- ◆ FARECLA G MOP

- Removes P1500 abrasive marks quickly and easily
- For use on modern paint systems – medium solids and high solids
- Use with water to achieve a perfect finish in one operation
- Silicone free
- Also available in 250g
- For hand or machine application



PRODUCT INFORMATION **J K L M Q S**

To achieve the best results use with Farécla Advanced G Mop Compounding Foam, available in fixed head or hook and loop.

### For harder paintwork



- ◆ FARECLA G6 RAPID GRADE PASTE COMPOUND
- ◆ FARECLA G MOP

- Removes P1500 abrasive paper marks quickly and easily
- For use on well cured medium solids or air dried 2K
- Use with water to achieve a perfect finish
- Silicone free
- For hand or machine application



If a more aggressive cut is required, use the Farécla Advanced G Mop Wool Compounding Pad.

PRODUCT INFORMATION **R**

To achieve the best results use with Farécla Advanced G Mop Compounding Foam, available in fixed head or hook and loop.

PRODUCT INFORMATION **J K L M Q S**



PRODUCT INFO



**NEW**



PRODUCT INFORMATION **F G**

### For well cured high solids paint

- ◆ FARECLA ADVANCED G4 LIQUID/G4 PASTE
- ◆ FARECLA ADVANCED G MOP LAMBSWOOL PAD

- Developed for use on high solids paint systems
- Provides a high gloss finish in one easy step
- Specialist soft wool applicator provides maximum cut whilst minimising swirl marks
- Silicone free
- For machine application



**N**

PRODUCT INFORMATION **N P**



**EW**

### For removal of holograms

- ◆ FARECLA ADVANCED G4 LIQUID
- ◆ FARECLA ADVANCED G MOP

- Specially developed to remove holograms from OE paintwork
- Provides a high gloss swirl free finish
- Silicone free
- For machine application only



PRODUCT INFORMATION T U



To achieve the best results use with Farécla Advanced G Mop Compounding Foam, followed by Farécla Advanced G Mop Polishing Foam.

PRODUCT INFORMATION J K L M Q S

RODUCT INFORMATION G

### For blow-ins and fade outs

- ◆ FARECLA G10 EXTRA FINE GRADE
- ◆ FARECLA G MOP

- Extra fine grade for soft or delicate paintwork
- Blends in finish paintwork to the original paint finish
- Silicone free
- For hand or machine application



PRODUCT INFORMATION J K L M Q S

To achieve the best results use with Farécla Advanced G Mop Compounding Foam, available in fixed head or hook and loop.



PRODUCT INFORMATION E

### For cellulose paint

- ◆ FARECLA G7

- Removes abrasive paper marks from cellulose paint
- For hand application only



PRODUCT INFORMATION D



#### TOP TIP

Use a fine mist of water during compounding. The water helps to breakdown the abrasive particles and polishes the surface to achieve the ultimate finish.\*

\*Not for use with Farécla Total Dry Use System



**NEW**

PRODUCT INFORMATION H

### For dry surface use

- ◆ FARECLA TOTAL DRY USE COMPOUND
- ◆ FARECLA TOTAL DRY USE APPLICATOR

- Removes P1500 abrasive paper marks
- Specialist applicator developed for use with Total Dry Use Compound
- Unique formulation provides a fast cutting action and a high gloss finish in one operation
- Silicone free
- For hand or machine application



PRODUCT INFORMATION V W

PRODUCT	CODE	PACK SIZE	CTN QTY	VOC
A Advanced G3 Liquid	AG3-700	500 ml	12	78.5g
	AG3-1400	1 Litre	6	157g
	AG3-5300	US Gallon	2	597g
B G3 Regular Grade Paste	G3-250	250g	24	28g
	G3-400	400g	12	44.8g
	G3-1000	1Kg	12	112g
	G3-3000	3Kg	4	336g
C G6 Rapid Grade Paste	G6-400	400g	12	44.8g
	G6-3000	3Kg	4	336g
D G7	G7-3000	3Kg	4	747g
E G10 Extra Fine Grade	G10-500	500 ml	12	96g
	G10-1000	1 Litre	6	193g
F G4 Paste	G4-400	400g	12	38g
G Advanced G4 Liquid	AG4-1300	1 Litre	6	176.8g
H Total Dry Use Liquid	TOT-1500	1 Litre	6	170g
J Standard G Mop	SGM-14	14mm	12 / 60	Nil
	SGM-58	5/8"	12 / 60	
	SGM-16	16mm	12 / 60	
K Advanced G Mop Compounding Head 6"	AGM-14	14mm	12	Nil
	AGM-58	5/8"	12	
	AGM-16	16mm	12	
L Advanced G Mop Compounding Foam 6"	AGM-CF	Foam	12	Nil
M Advanced G Mop Back Plate 6"	AGM-BPI14	14mm	6	Nil
	AGM-BP58	5/8"	6	
	AGM-BPI16	16mm	6	
N Advanced G Mop Lambswool Pad 6"	AGM-LWP	Wool	6	Nil
P Advanced G Mop Back Plate with Interface Pad 6"	AGM-BPIP14	14mm	6	Nil
	AGM-BPIP58	5/8"	6	
	AGM-BPIP16	16mm	6	
Q Advanced G Mop Compounding Foam 8"	AGM-CF8	Foam	6	Nil
R Advanced G Mop Wool Compounding Pad 8"	AGM-WCP8	Wool	6	Nil
S Advanced G Mop Back Plate 8"	AGM-BP814	14mm	6	Nil
	AGM-BP858	5/8"	6	
	AGM-BP816	16mm	6	
T Advanced G Mop Polishing Foam 6"	AGM-PF	2 x foams	12	Nil
U Advanced G Mop Polishing Foam 8"	AGM-PF8	Foam	6	Nil
V Total Dry Use Compounding Foam 6"	TOT-CF	2 x foams	12	Nil
W Total Dry Use Backing Plate 6"	TOT-BPIP14	14mm	6	Nil
	TOT-BPIP58	5/8"	6	
	TOT-BPIP16	16mm	6	
X Farécla Water Spray Bottle	WSB	600ml	25	Nil

Full material safety data sheet is available on request



### For removal of swirl marks

- ◆ FARECLA G10 EXTRA FINE GRADE LIQUID
- ◆ FARECLA ADVANCED G MOP POLISHING FOAM



- Permanently removes swirl marks left by wool or foam compounding applicators
- Cleans and restores discoloured surfaces
- Improves the gloss level, especially on dark colours
- Silicone free
- For use by hand or machine



To achieve the best results use with Farécla Advanced G Mop Polishing Foam, available in hook and loop.

To achieve the ultimate showroom finish, especially on dark colours, or to enhance the look of the whole vehicle for customer satisfaction, use a Farécla hand or machine finishing system.



### For the ultimate machine finish

- ◆ FARECLA GOLD TOP MACHINE GLAZE
- ◆ FARECLA ADVANCED G MOP POLISHING FOAM

- Provides a long lasting high gloss finish
- Will withstand final valet wash
- Does not dry up in use, so can work on large areas at a time
- Contains water repellent properties



To achieve the best results use with Farécla Advanced G Mop Polishing Foam, available in hook and loop.



### For the ultimate finish by hand

- ◆ FARECLA BLACK TOP HAND GLAZE
- ◆ FARECLA FINISHING CLOTH

- Provides a long lasting high gloss finish
- Will withstand final valet wash
- Does not dry out in use
- Contains water repellent properties

For optimum results, use a Farécla Finishing Cloth



PRODUCT	CODE	PACK SIZE	CTN QTY	VOC
G10 Extra Fine Grade Liquid	G10-500	500ml	12	96g
	G10-1000	1 Litre	6	193g
Advanced G Mop Polishing Foam 6"	AGM-PF	2 x foams	12	Nil
Advanced G Mop Back Plate 6"	AGM-BP14	14mm	6	Nil
	AGM-BP58	5/8"	6	
	AGM-BP16	16mm	6	
Advanced G Mop Polishing Foam 8"	AGM-PF8	Foam	6	Nil
Advanced G Mop Back Plate 8"	AGM-BP814	14mm	6	Nil
	AGM-BP858	5/8"	6	
	AGM-BP816	16mm	6	

Full material safety data sheet is available on request

PRODUCT	CODE	PACK SIZE	CTN QTY	VOC
Black Top Hand Glaze	BT-500	500ml	12	Nil
	BT-1000	1 Litre	6	
Gold Top Machine Glaze	GT-500	500ml	12	148g
	GT-1000	1 Litre	6	296g
Advanced G Mop Polishing Foam 6"	AGM-PF	2 x foams	12	Nil
Advanced G Mop Back Plate 6"	AGM-BP14	14mm	6	Nil
	AGM-BP58	5/8"	6	
	AGM-BP16	16mm	6	
Advanced G Mop Polishing Foam 8"	AGM-PF8	Foam	6	Nil
Advanced G Mop Back Plate 8"	AGM-BP814	14mm	6	Nil
	AGM-BP858	5/8"	6	
	AGM-BP816	16mm	6	
Finishing Cloth	FC-3	3	12	Nil
	FC-100	100	1	Nil

Full material safety data sheet is available on request

**A practical guide to help you gain the most from your chosen system:**

**Preparation**

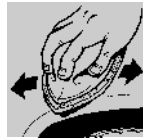

Use pointed end of block around awkward areas

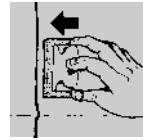

Use flat end of block up to edge of panels

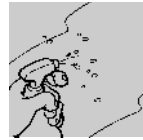

Use water from a spray bottle to aid detergent

**Rectification foam applicator**

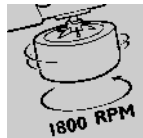

Use at speed of 1800 RPM free running (1500 RPM for 8" foam)

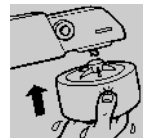

Soak G Mop before use and spin off excess



Spray with water frequently during use



Regularly wash the G Mop to prolong the life of the foam

**Rectification 8" wool applicator**

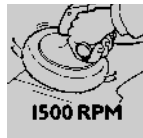

Use at speed of 1500 RPM free running



Spray with water during use to enhance finish

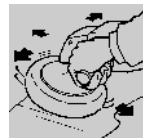

Keep the mop moving



Regularly spin the G Mop to prolong the life of the applicator

**Glaze finishing by hand**



Only apply a little product at a time, you can add more if you need to



For the optimum finish, use a Farécla Finishing Cloth for final buffing

**Glaze finishing by machine**



Only apply a little product at a time, you can add more if you need to



Keep the mop moving

At Farécla we believe passionately in working closely with our customers, gaining a better understanding of their needs in today's busy bodyshop environment, and anticipating their needs for tomorrow.

We are also committed to providing training and practical advice to improve application techniques, helping to speed up each process.



**Contact us for Advice**

If you have a technical question or need some advice you can contact us by phone on +44 (0)1920 465 041 or fax +44 (0)1920 466 557

or e-mail us at [enquiries@farecla.com](mailto:enquiries@farecla.com)

Alternatively you can write to us at:

Farécla Products Limited, Broadmeads, Ware Hertfordshire, SG12 9HS UK



**www.farecla.com**

Visit our new website at [www.farecla.com](http://www.farecla.com) – here you'll find all the information you need regarding the current product range and forthcoming products. Or you can download up-to-date health and safety information.

**Training Material**

A practical guide to preparation, rectification and finishing techniques is available on video and on CD Rom. Each provides easy to follow step-by-step techniques and is packed with handy hints and tips. To request your copy please e-mail us or call us on +44 (0)1920 465 041.

